

Dover 14/15 Replacement Parts

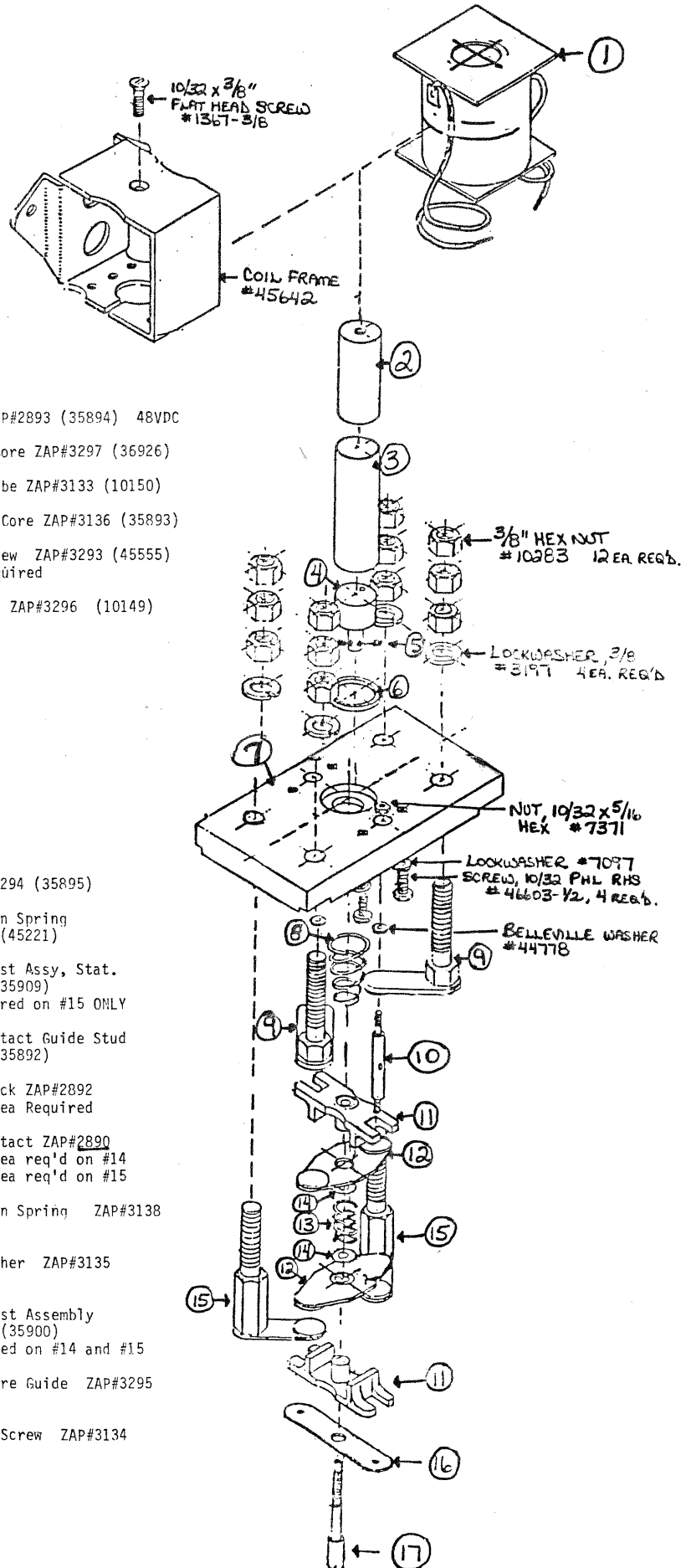

1. Coil ZAP#2893 (35894) 48VDC
2. Fixed Core ZAP#3297 (36926)
3. Core Tube ZAP#3133 (10150)
4. Moving Core ZAP#3136 (35893)
5. Set Screw ZAP#3293 (45555)
2ea Required
6. Washer ZAP#3296 (10149)
7. Base ZAP#3294 (35895)
8. Compression Spring ZAP#3137 (45221)
9. Contact Post Assy, Stat. ZAP#2891 (35909)
2ea Required on #15 ONLY
10. Moving Contact Guide Stud ZAP#3292 (35892)
11. Cradle Block ZAP#2892 (10074) 2ea Required
12. Moving Contact ZAP#2890 (35890) 1ea req'd on #14
2ea req'd on #15
13. Compression Spring ZAP#3138 (25249)
14. Teflon Washer ZAP#3135 (41111)
15. Contact Post Assembly ZAP#2889 (35900)
2ea Required on #14 and #15
16. Movable Core Guide ZAP#3295 (35902)
17. Retaining Screw ZAP#3134 (35891)

**👉 We also stock the
complete relays:
#14 -- Zap #2887
#15 -- Zap #2888**